



250 Staunton Turnpike, Parkersburg, WV 26104

500 SERIES

Vinyl Horizontal Sliding Window

w/ Nailing Fin

"NON-IMPACT"

GENERAL NOTES

1. This product has been evaluated and is in compliance with the 8th Edition (2023) Florida Building Code (FBC) structural requirements excluding the "High Velocity Hurricane Zone" (HVHZ).
2. Product anchors shall be as listed and spaced as shown on details. Anchor embedment to base material shall be beyond wall dressing or stucco.
3. When used in areas requiring wind borne debris protection this product is required to be protected with an impact resistant covering that complies with FBC Sections 1609.1.2 & R301.2.1.2.
4. For 2x stud framing construction, anchoring of these units shall be the same as that shown for 2x buck masonry construction. Increase anchor length to account for exterior sheathing.
5. Site conditions that deviate from the details of this drawing require further engineering analysis by a licensed engineer or registered architect.

| TABLE OF CONTENTS | |
|-------------------|--|
| SHEET# | DESCRIPTION |
| 1 | Typical elevations, design pressures and general notes |
| 2 | Horizontal and vertical cross sections |
| 3 | Buck and frame anchoring |
| 4 | Bill of materials, components & glazing details |

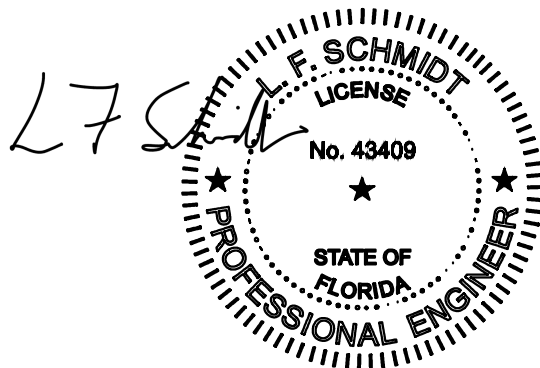

This item has been digitally signed and sealed by L. F. Schmidt, P.E. on the date adjacent to the seal. Printed copies of this document are not considered signed and sealed and the signature must be verified on any electronic copies.

THIS PRODUCT APPROVAL IS VALID ONLY FOR THE STATE OF FLORIDA

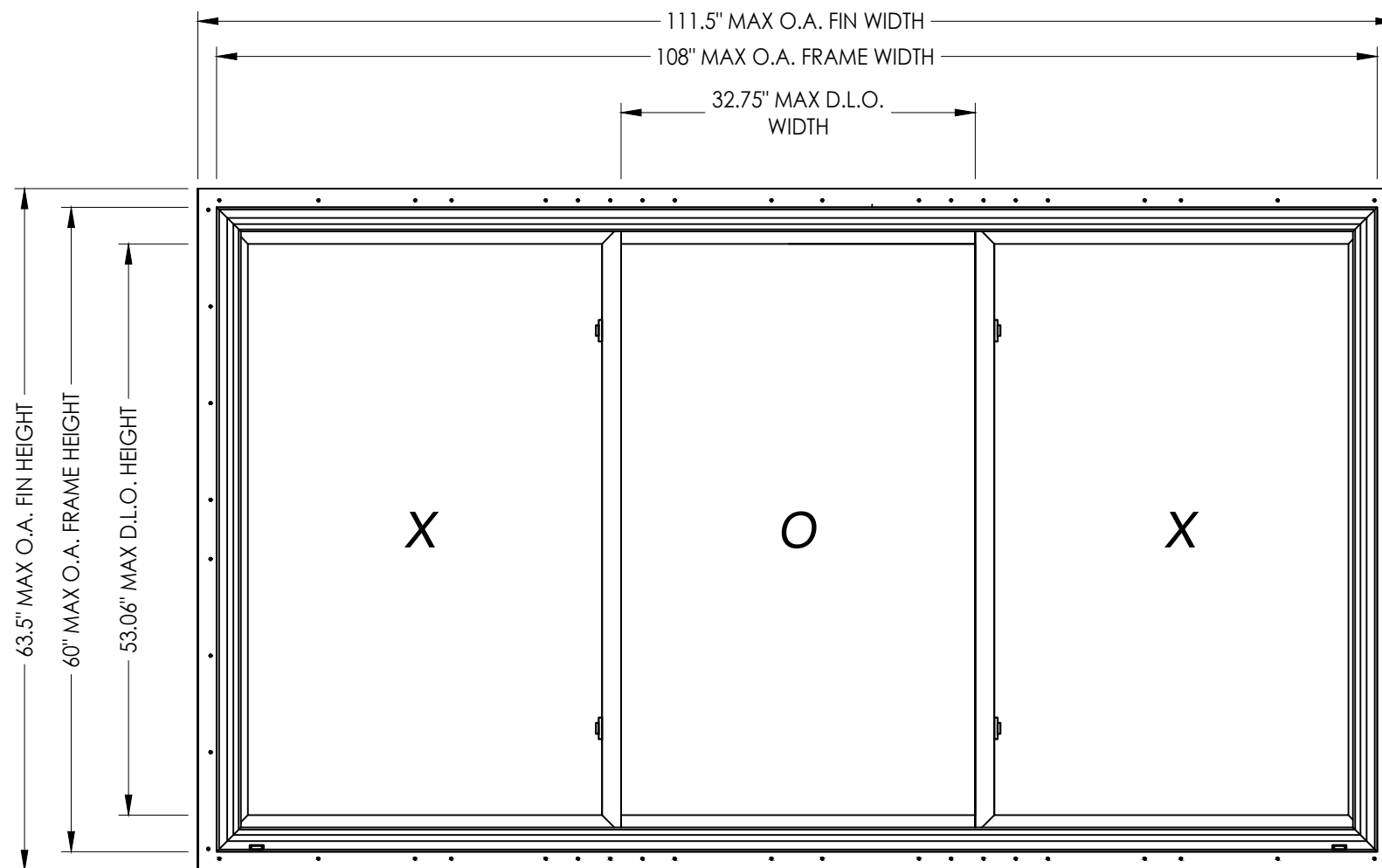

| MAX. FIN DIMENSION | MAX. FRAME DIMENSION | MAX. D.L.O. DIMENSION | GLASS TYPE | DESIGN PRESSURE (PSF) | |
|--------------------|----------------------|-----------------------|------------|-----------------------|----------|
| | | | | POSITIVE | NEGATIVE |
| 111.5" X 63.5" | 108.0" X 60.0" | 32.75" X 53.06" | G1 | +25.0 | -25.0 |

Documents Prepared By:
Lyndon F. Schmidt
P.E. No. 43409

RW BUILDING CONSULTANTS, INC.
P.O. Box 230, Vairico, FL 33595
Phone No.: 813.659.9197
FBPE Registry No. 9813

PRODUCT: 500 SERIES
1/3-1/3-1/3

PART OR ASSEMBLY:
TYPICAL ELEVATION, DESIGN PRESSURES & GENERAL NOTES

| NO. | DATE | REVISIONS |
|-----|---------|------------------------------|
| 4 | 7/06/23 | UPDATE TO 8TH ED. (2023) FBC |
| 3 | 7/06/20 | UPDATE TO 7TH ED. (2020) FBC |
| 2 | 6/01/17 | UPDATE TO 6TH ED. (2017) FBC |
| 1 | 1/28/15 | UPDATE TO 5TH ED. (2014) FBC |
| | | BY |

DATE: 10/4/13
SCALE: N.T.S.
DWG. BY: JK
CHK. BY: LFS
DRAWING NO.: FL-16092.17
SHEET 1 OF 4

Z:\2023 FBC Drawings\Wincore Window Company\FL-16092 R9\FL-16092.15-17.dwg

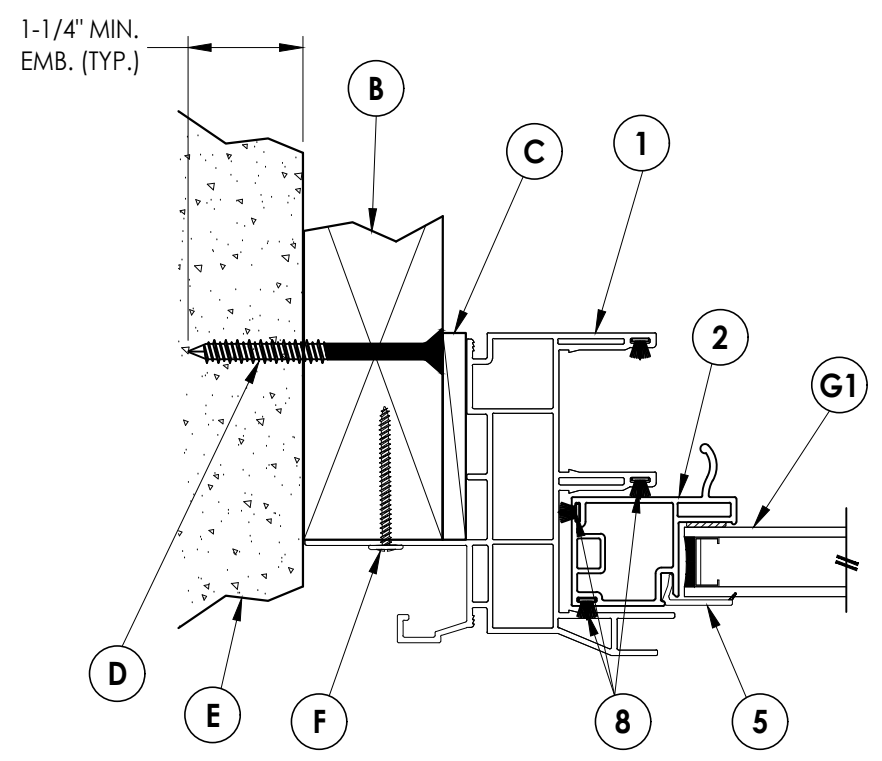
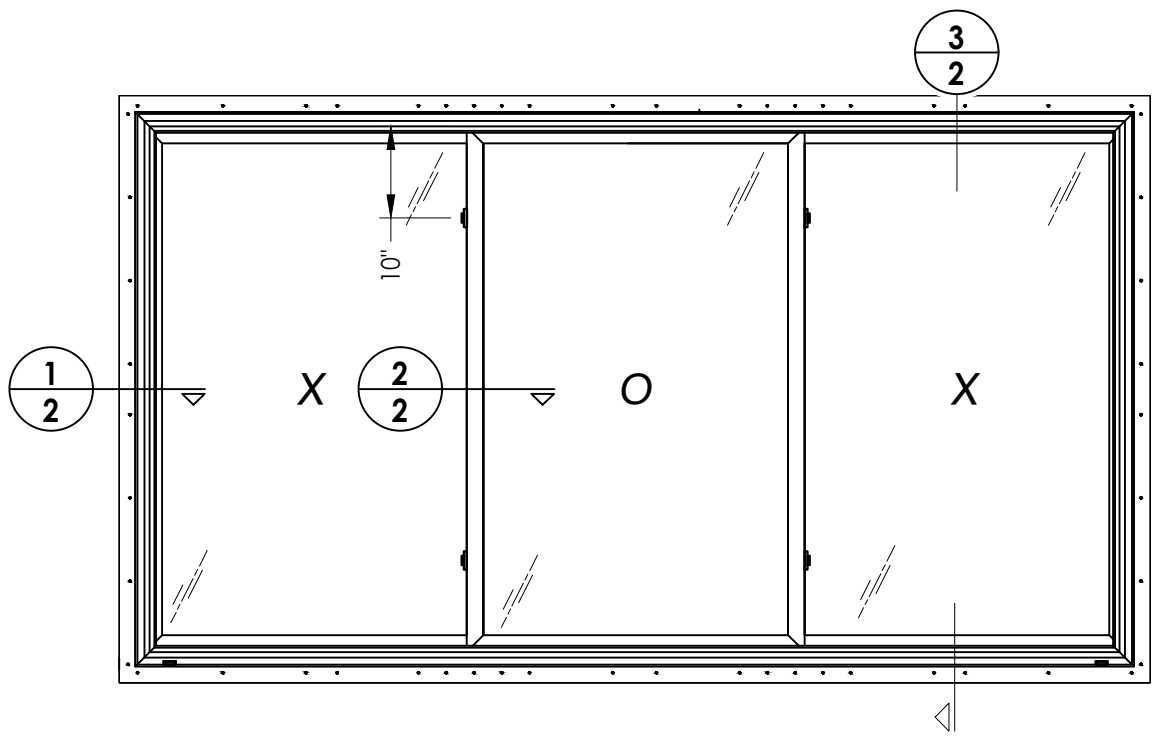

1
2 HORIZONTAL CROSS SECTION

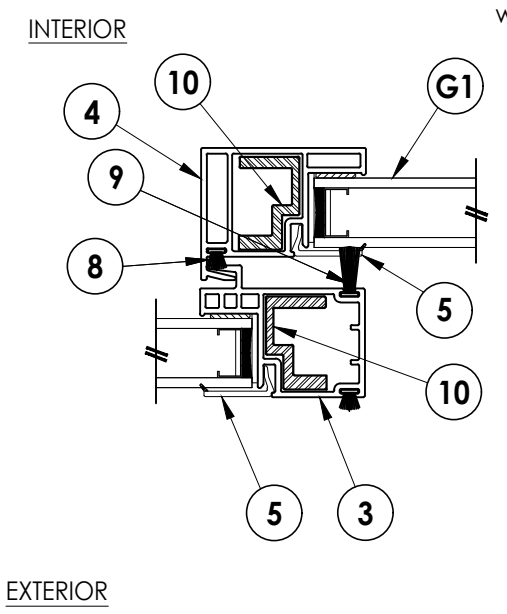

2
2 HORIZONTAL CROSS SECTION

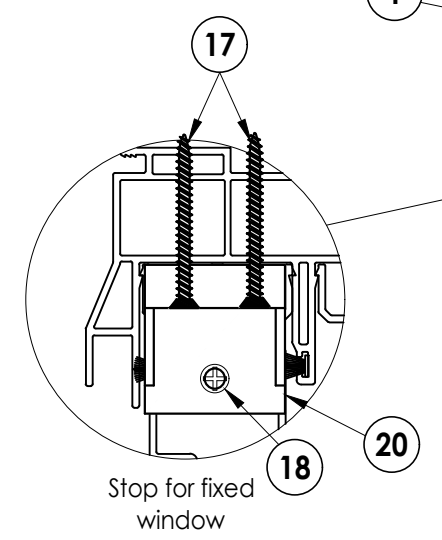

Stop for fixed window

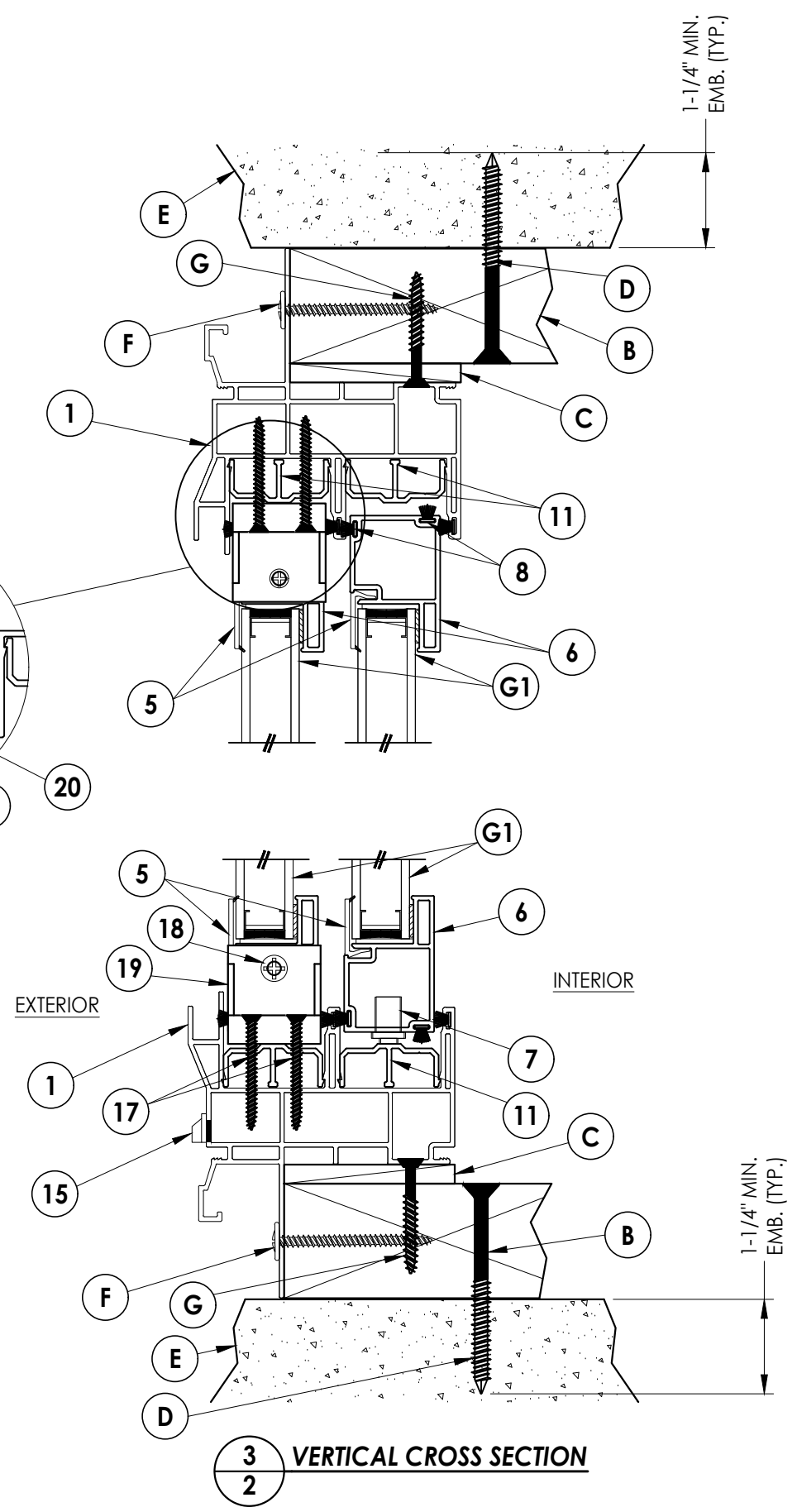

3
2 VERTICAL CROSS SECTION

Documents Prepared By:
Lyndon F. Schmidt
P.E. No. 43409

RW BUILDING CONSULTANTS, INC.
P.O. Box 230, Vairico, FL 33595
Phone No.: 813.659.9197
FBPE Registry No. 9813

PRODUCT:
500 SERIES
1/3-1/3-1/3

PART OR ASSEMBLY:
HORIZONTAL AND VERTICAL
CROSS SECTIONS

| NO. | DATE | BY |
|-----|---------|----------------------------------|
| 4 | 7/06/23 | UPDATE TO 8TH ED. (2023) FBC LFS |
| 3 | 7/06/20 | UPDATE TO 7TH ED. (2020) FBC LFS |
| 2 | 6/01/17 | UPDATE TO 6TH ED. (2017) FBC JK |
| 1 | 1/28/15 | UPDATE TO 5TH ED. (2014) FBC JK |

DATE: 10/4/13
SCALE: N.T.S.
DWG. BY: JK
CHK. BY: LFS
DRAWING NO.: FL-16092.17
SHEET 2 OF 4

© 2013 R.W. BUILDING CONSULTANTS INC.

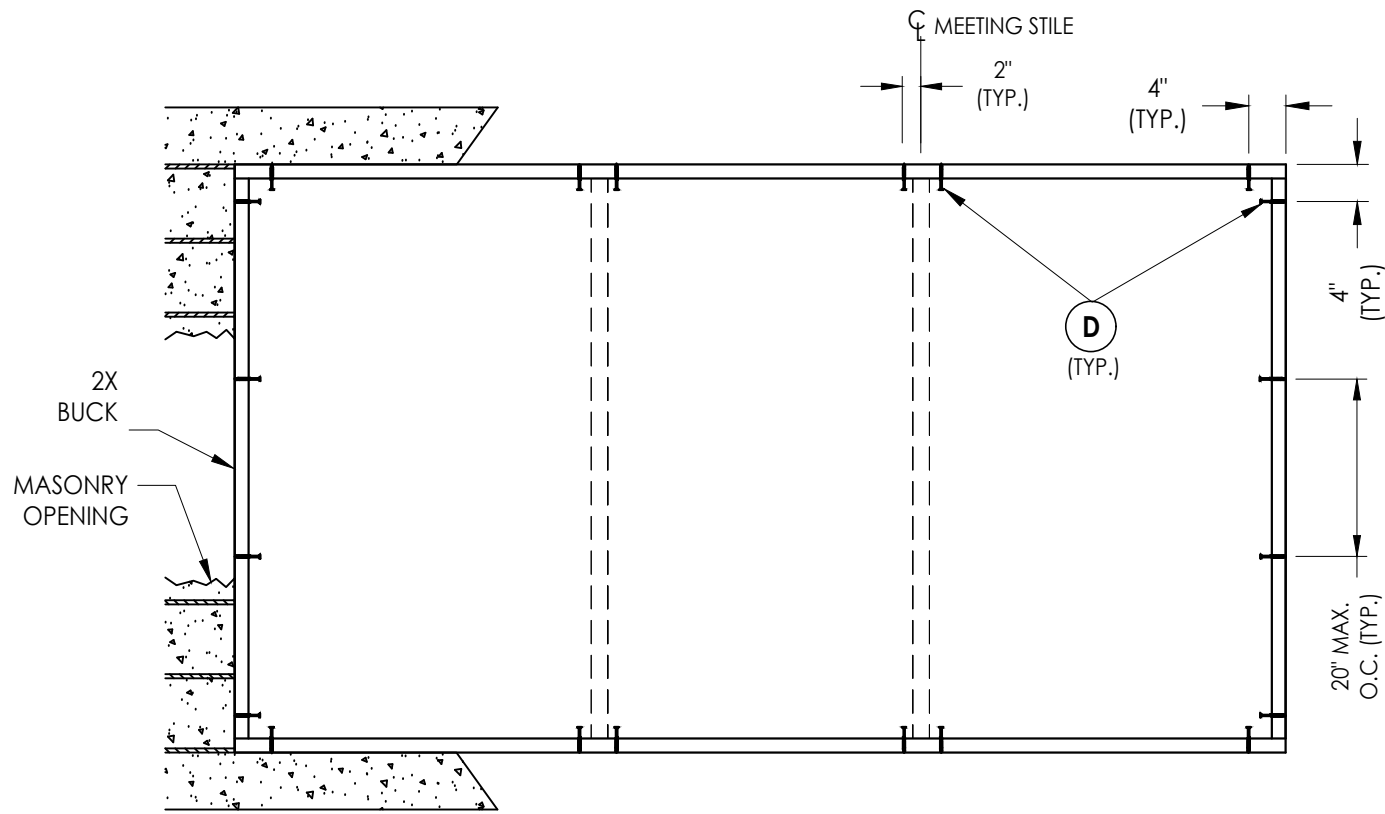

BUCK ANCHORING

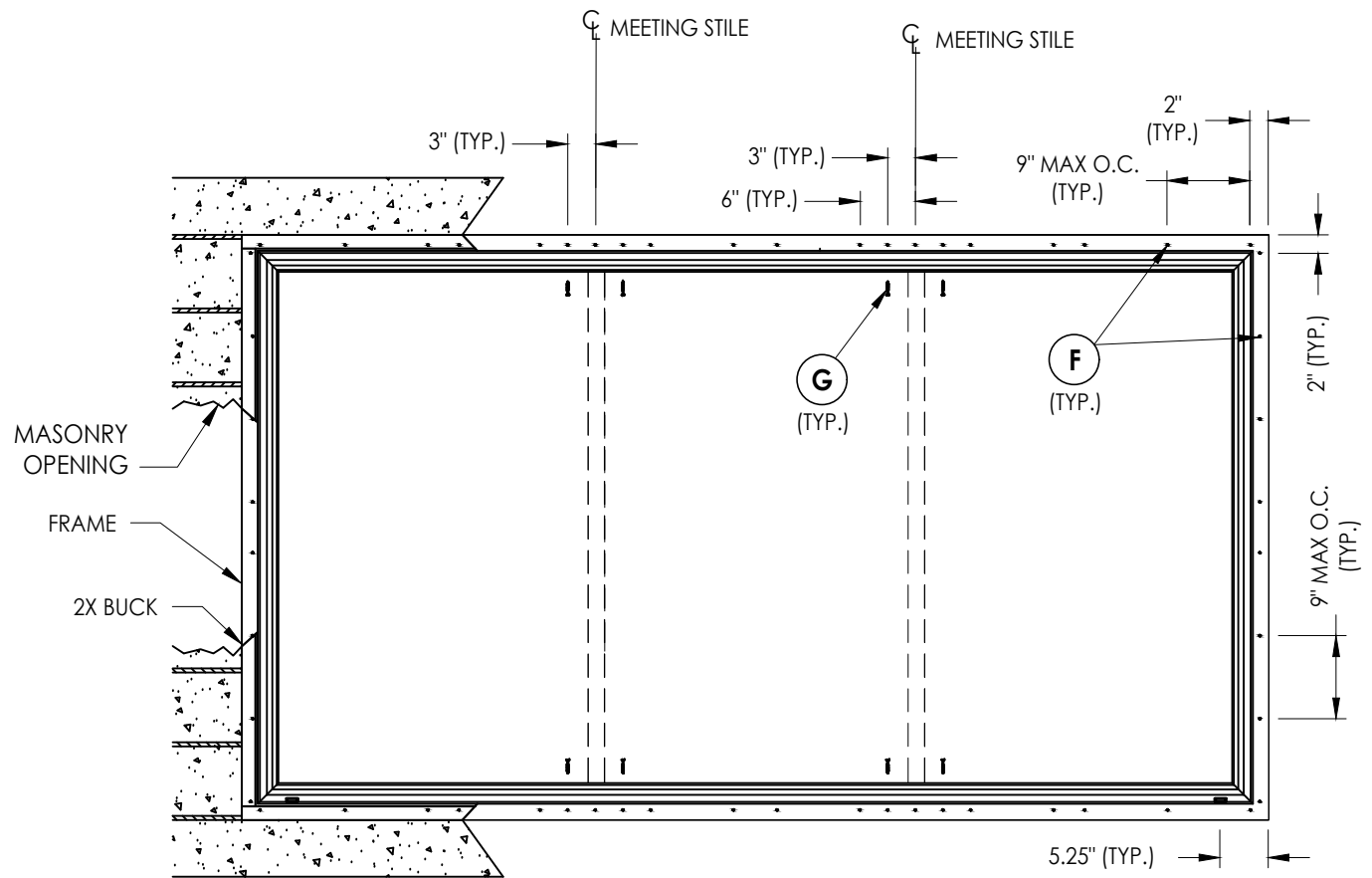

FRAME ANCHORING

CONCRETE ANCHOR NOTES:

1. Concrete anchor locations at the corners may be adjusted to maintain the min. edge distance to mortar joints.
2. Concrete anchor locations noted as "MAX. ON CENTER" must be adjusted to maintain the min. edge distance to mortar joints, additional concrete anchors may be required to ensure the "MAX. ON CENTER" dimension are not exceeded.
3. Concrete anchor table:

| ANCHOR TYPE | ANCHOR SIZE | MIN. EMBEDMENT | MIN. CLEARANCE TO MASONRY EDGE | MIN. CLEARANCE TO ADJACENT ANCHOR |
|------------------|-------------|----------------|--------------------------------|-----------------------------------|
| ITW TAPCON® | 1/4" | 1-1/4" | 2" | 4" |
| DeWALT ULTRACON® | 1/4" | 1-1/4" | 1" | 4" |

WOOD SCREW INSTALLATION NOTES:

1. Maintain a minimum 5/8" edge distance, 1" end distance, & 1" o.c. spacing of wood screws to prevent the splitting of wood.

Documents Prepared By:
Lyndon F. Schmidt
P.E. No. 43409

RW BUILDING CONSULTANTS, INC.
P.O. Box 230, Vairico, FL 33595
Phone No.: 813.659.9197
FBPE Registry No. 9813

PRODUCT:
500 SERIES
1/3-1/3-1/3

PART OR ASSEMBLY:
BUCK AND FRAME ANCHORING

| NO. | DATE | REVISIONS |
|-----|---------|----------------------------------|
| 4 | 7/06/23 | UPDATE TO 8TH ED. (2023) FBC LFS |
| 3 | 7/06/20 | UPDATE TO 7TH ED. (2020) FBC LFS |
| 2 | 6/01/17 | UPDATE TO 6TH ED. (2017) FBC LFS |
| 1 | 1/28/15 | UPDATE TO 5TH ED. (2014) FBC JK |

DATE: 10/4/13

SCALE: N.T.S.

DWG. BY: JK

CHK. BY: LFS

DRAWING NO.:

FL-16092.17

SHEET 3 OF 4

BILL OF MATERIALS

| ITEM # | DESCRIPTION | Part # | MATERIAL |
|--------|--|-----------|----------|
| A | 1X BUCK (SG >= 0.42) | - | WOOD |
| B | 2X BUCK (SG >= 0.42) | - | WOOD |
| C | 1/4" MAX. SHIM SPACE | - | - |
| D | 1/4" X 2-3/4" PFH DeWALT OR ITW CONCRETE SCREW | - | STEEL |
| E | MASONRY - 3,000 PSI MIN. CONCRETE CONFORMING TO ACI 301 OR HOLLOW BLOCK CONFORMING TO ASTM C90 | - | CONCRETE |
| F | #8 X 1-1/2" MODIFIED TRUSS HEAD (7/16" Ø) SMS (1-3/8" MIN. EMB.) | - | STEEL |
| G | #10 X 1-1/2" PFH WOOD SCREW (1-1/4" EMBEDMENT) | - | STEEL |
| 1 | FRAME("J" CHANNEL)* | DS5401E | PVC |
| 2 | SLIDER PULL STILE* | SE4647 | PVC |
| 3 | LOCK STILE* | SE4646 | PVC |
| 4 | KEEPER STILE* | SE4644 | PVC |
| 5 | GLAZING BEAD* | 22841 | PVC |
| 6 | SLIDER COMMON RAIL* | SE4645 | PVC |
| 7 | METAL ROLLERS w/ PLASTIC HOUSING | - | - |
| 8 | WEATHERSTRIP (0.230") | - | - |
| 9 | WEATHERSTRIP (0.380") | - | - |
| 10 | REINFORCEMENT (6063-T6 ALUM) | - | ALUM |
| 11 | SILL TRACK* | V777 | PVC |
| 15 | WEEPHOLE CAP* | WEEP-1288 | PVC |
| 17 | #8 X 1-1/4" PFH SMS | - | STEEL |
| 18 | #8 X 3/4" PFH WOOD SCREW | - | STEEL |
| 19 | LOWER FLANKER STOP | 2991C | NYLON |
| 20 | UPPER FLANKER STOP | 2991B | NYLON |

* THE APPROVED WHITE RIGID PVC EXTERIOR EXTRUSIONS FOR WINDOWS ARE TO BE PRODUCED BY EXTRUDERS LICENSEES IN "AAMA CERTIFICATION PROGRAMS FOR RIGID PVC EXTRUSIONS".

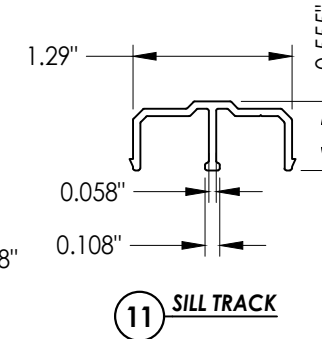
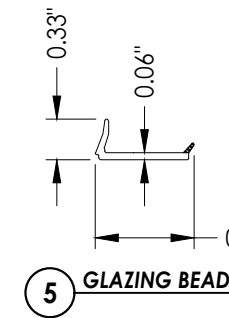
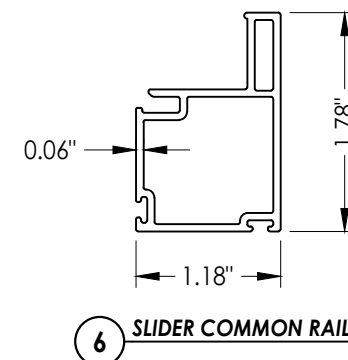
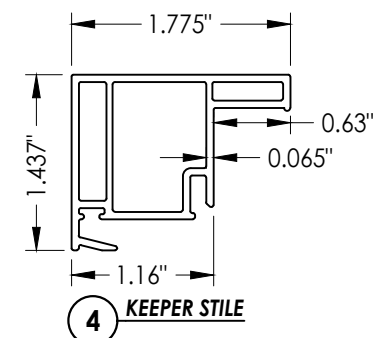
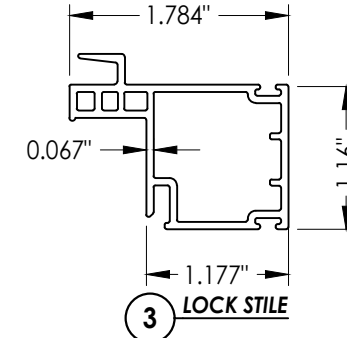
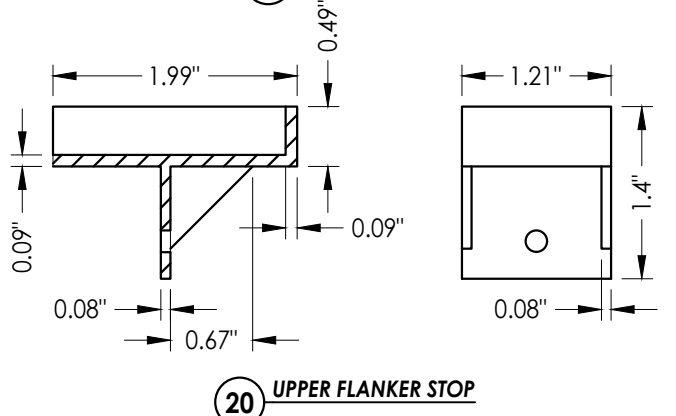
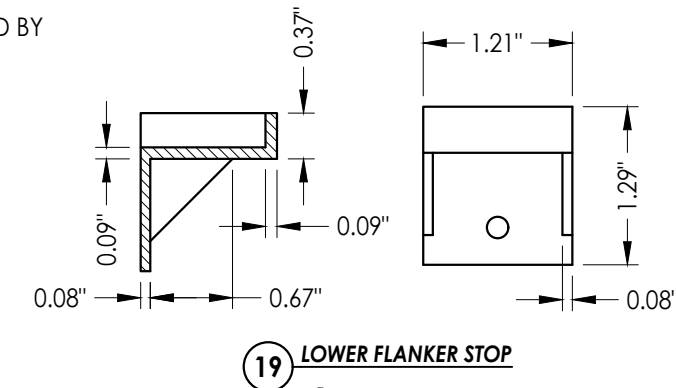
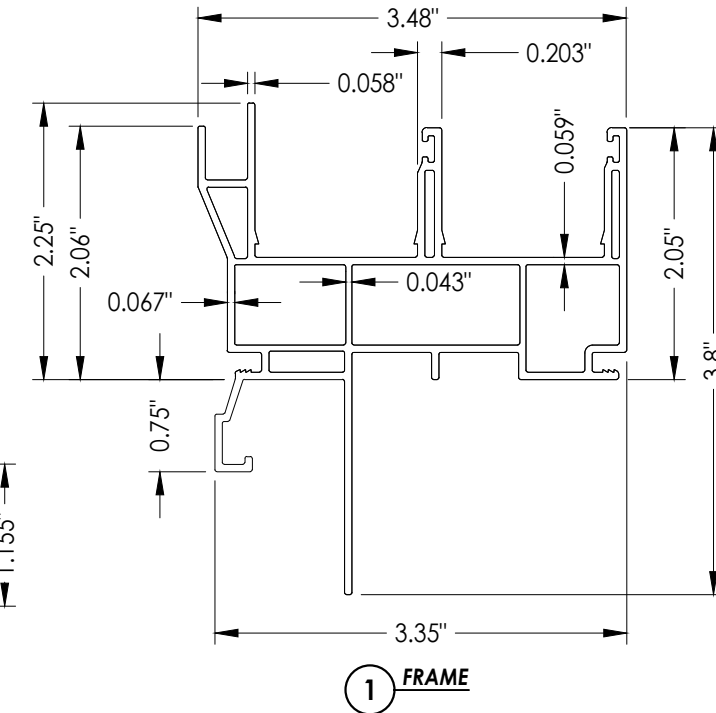
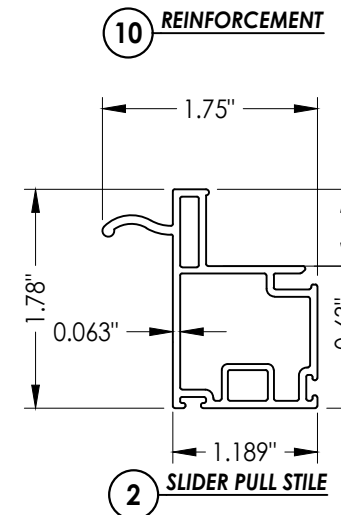
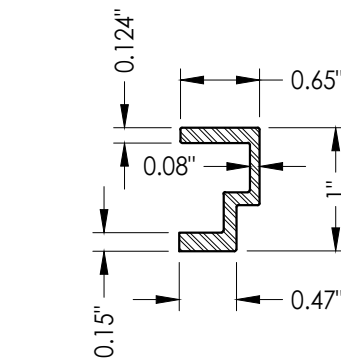
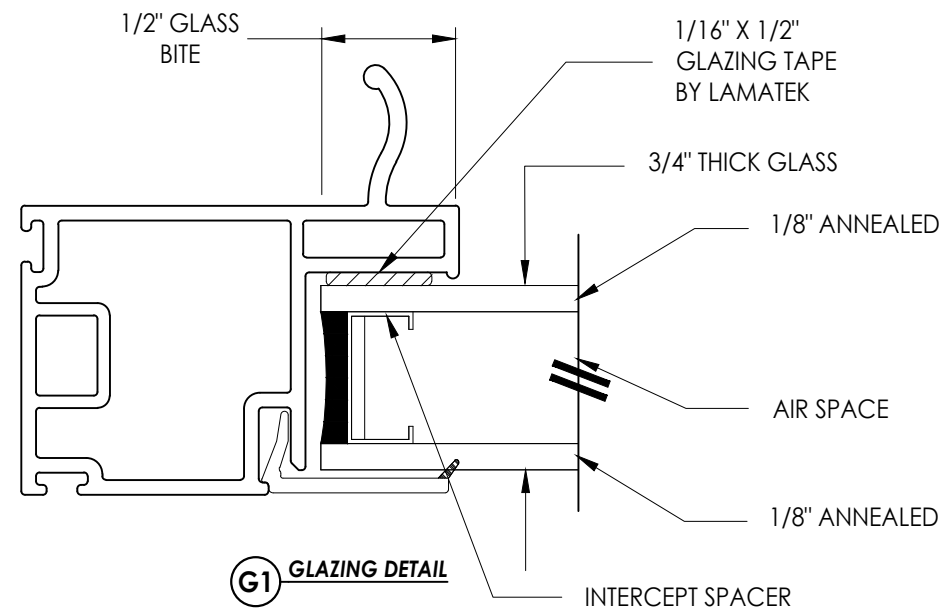

Documents Prepared By:
Lyndon F. Schmidt
P.E. No. 43409

RW BUILDING CONSULTANTS, INC.
P.O. Box 230, Valrico, FL 33595
Phone No.: 813.659.9197
FBPE Registry No. 9813

PRODUCT: 500 SERIES
1/3-1/3-1/3
PART OR ASSEMBLY:
BILL OF MATERIALS, COMPONENTS
& GLAZING DETAILS

| NO. | DATE | BY |
|-----|---------|-----|
| 4 | 7/06/23 | FBC |
| 3 | 7/06/20 | FBC |
| 2 | 6/01/17 | FBC |
| 1 | 1/28/15 | FBC |

REVISIONS

DATE: 10/4/13
SCALE: N.T.S.
DWG. BY: JK
CHK. BY: LFS
DRAWING NO.: FL-16092.17
SHEET 4 OF 4